

**Compressors**

SELECTED ON 40 DB & 22 WB OUTDOOR CONDITION.

No.	location	Cooling Capacity	Electrical Power KW	Operating Temperature c°	Quantity	Diversity
		HP				
Compressor - 1	Cold Room 1-4	10	10	( +10)-(-20)	8	100%
Compressor - 2	Cold Room 5-8	15	15	( +10)-(-20)	8	

**Evaporators**

SELECTED TO MATCH THE RELATED COMPRESSOR

No.	location	Cooling Capacity	Electrical Power KW	Operating Temperature c°	Quantity	Diversity
		HP				
Evaoprator - 1	Cold Room 1-4	10	2.5	( +10)-(-20)	8	100%
Evaporator - 2	Cold Room 5-8	15	3.0	( +10)-(-20)	8	

**DEFROSTING BY REVERSE CYCLE HEAT PUMP INCLUDING HEATER FOR DRAIN PAN**

1. THE CONTRACTOR IS RESPONSIBLE FOR RE- CALCULATING AND VERIFYING THE TOTAL REQUIRED COOLING AND FREEZING LOAD. AND SHALL IMPLEMENT AND SUPPLY ANY ADDITIONAL VARIATIONS FROM THE REQUIRED LOAD WITHOUT ANY ADDITIONAL COST.
2. THE CONTRACTOR SHALL VERIFY THE REQUIRED ELECTRICAL LOAD ACCORDING TO THE FINAL SELECTED SIZE AND MODEL, AND ACCORDINGLY HE WILL ADJUST AND IMPLEMENT ANY REQUIRED ADDITIONAL AND/OR NECESSARY MEP WORKS NOT MENTIONED IN THE DRAWINGS OR IN THE BOQ AND WITHOUT ANY ADDITIONAL COST.

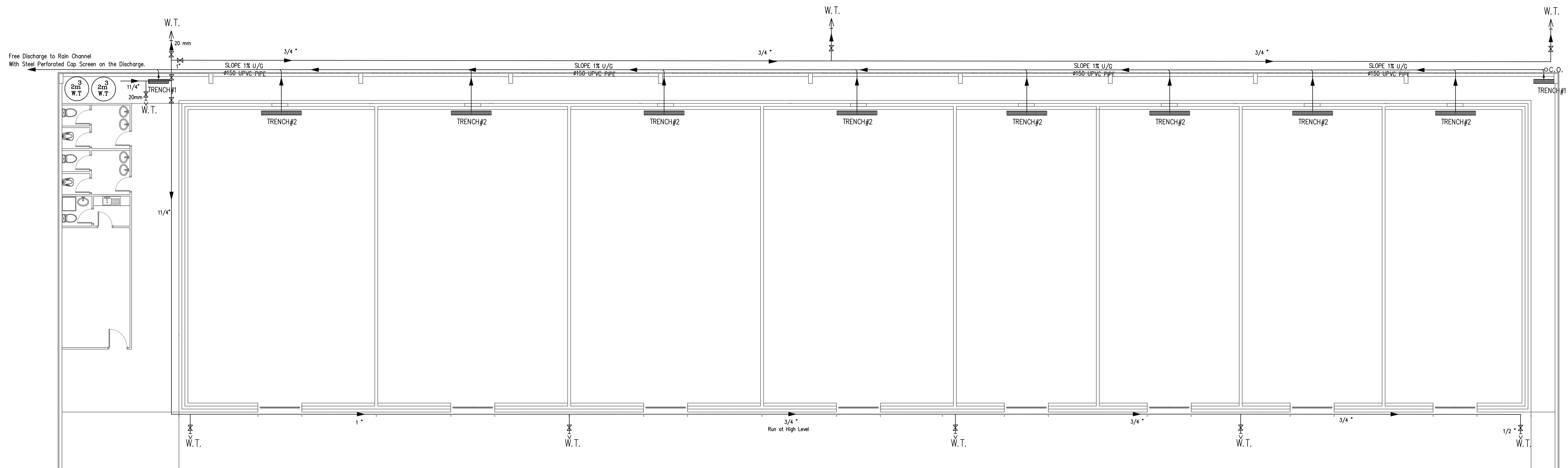

WATER PIPES FOR WATER TAPS SHALL BE GALVANIZED STEEL CLASS B, SUSPENDED @ HIGH LEVEL AND DROP DOWN FOR WATER TAPS @ 60 CM FROM F.F.L.

Refer to the specifications for more details regarding the cold room & floor constructions and the refrigeration system details.

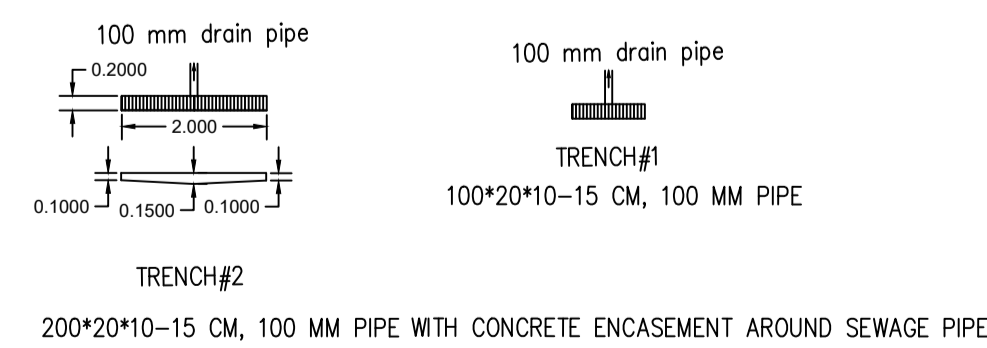

- ⊗ ISOLATING VALVE
- W.T. : 3/4" WATER TAP
- ⊕ 6" NON RETURN CHECK GATE

٤٠٤٦	التاريخ	م عبدالله هوش ٦٥١١	رسم	م عبدالله هوش ٦٥١١	تصميم المهندس	 <b>الرائد العربي</b> معماريون مهندسون مستشارون	البريموك الغربي	رقم الحوض	الشركة العامة الاردنية للصوامع و الترميم	المالك
٤م	رقم اللوحة	تصريف مياه غرف التبريد	اسم اللوحة	م عبدالله هوش ٦٥١١	تدقيق المهندس		٨٤	رقم القطعة	الرمثا	الموقع

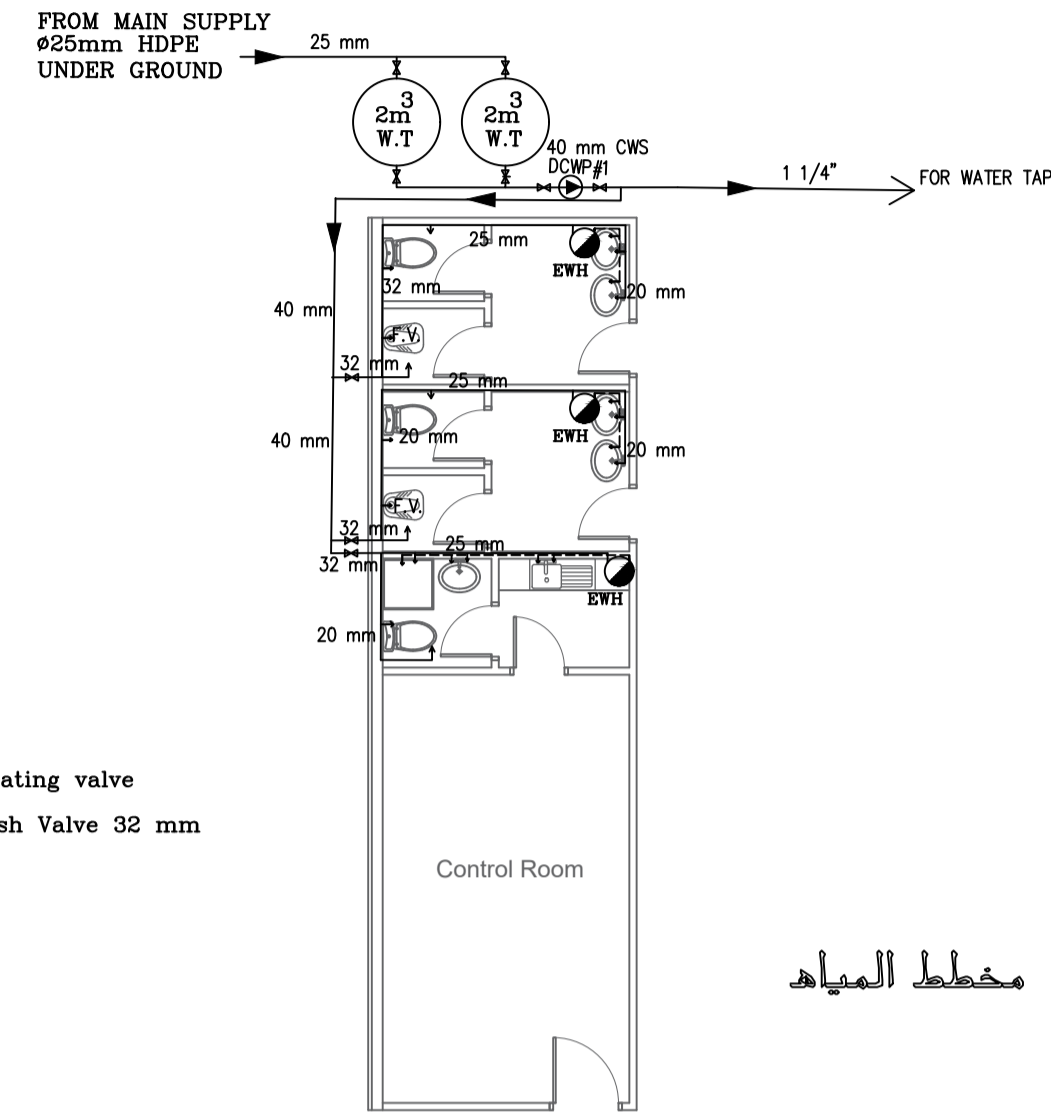

مخطط المياه

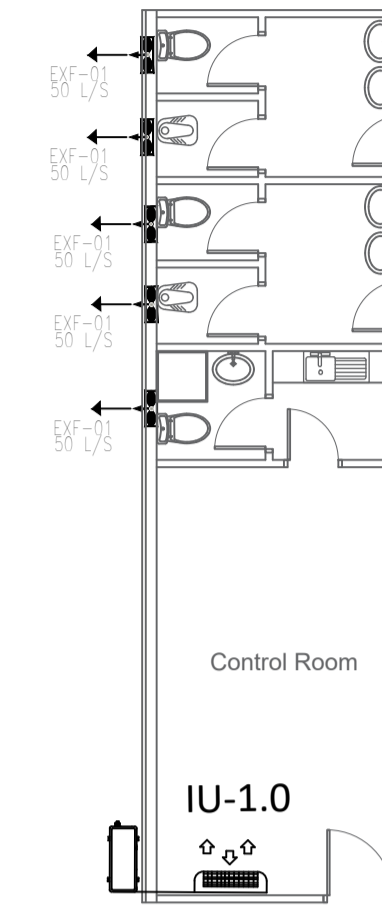
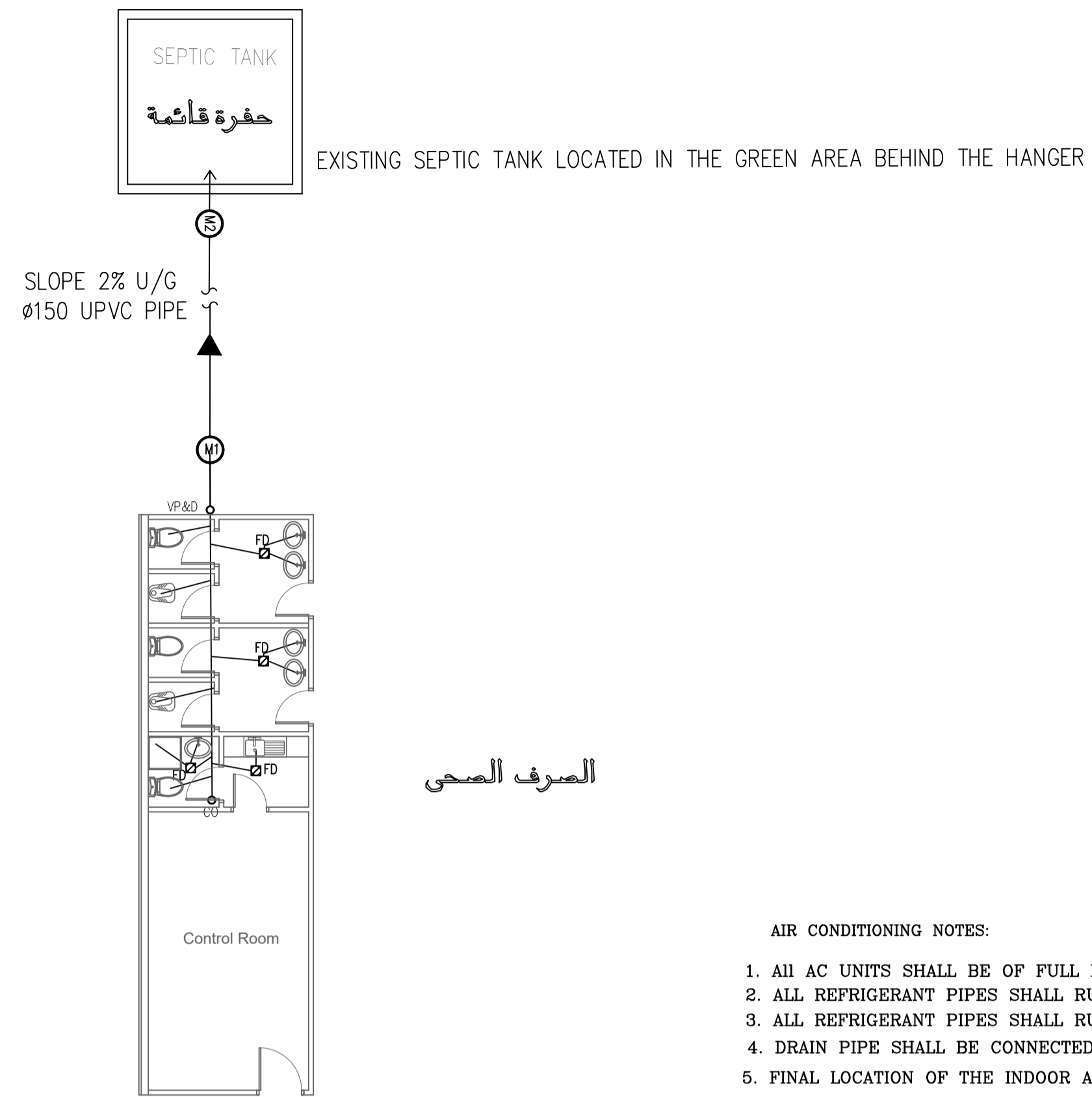

تكييف و تهوية

PIPES FOR WATER TAPS SHALL BE GALVANIZED STEEL CLASS B  
PIPES FOR TANKS AND INSIDE TOILETS SHALL BE CPVC PIPES.  
MAIN FEED PIPE TO TANKS SHALL BE HDPE PIPES.

DRAINAGE PIPE CONNECTIONS :  
UNLESS OTHERWISE INDICATED THE PIPE CONNECTION  
TO EACH SANITARY FIXTURE SHALL BE AS FOLLOW:

الوحدة الصحية	معدل التدفق
مرحاض طابقي	4.8 لتر / ساعة
مرحاض بمسدوق طرد شتات التدفق	3 لتر / ساعة للدفعة الاولى
	6 لتر / ساعة للدفعة الثانية
حطابيه	4.5 لتر / دقيقة عند ضغطها
حديبات في المباني المنزلية	4.5 لتر / دقيقة
حديبات في المباني التجارية	4.5 لتر / دقيقة
حديبة على منزلي	9.5 لتر / دقيقة
شاور	7.6 لتر / دقيقة
غسالة ملابس منزلية	8.75 لتر / عند غسل
جلابيه	22 لتر / دقيقة

NO.	Fixture	Diameter pipe
1	WC.	100mm UPVC
2	Basin	50mm UPVC
3	Bidet	50mm UPVC
4	Shower/Bathtub	50mm UPVC
5	Washing Mach.	50mm UPVC
6	Floor drain	100mm UPVC
7	Balconey FD	50mm UPVC
8	Sink	80mm UPVC
9	VP : Vent Pipe	100 mm UPVC
10	R.W.P. Rain Water Pipe	100 mm UPVC
11	R.W.D RAIN WATER DRAIN	100 mm UPVC
12	CO : Clean Out	100 mm UPVC
13	out door main sewage pipes	150 mm UPVC slope 2%

Branches Diameter

Fixture	Diameter	Pipe Material
Bath	20mm	Plastic Pex
W.C.	16mm	Plastic Pex
Bidet	16mm	Plastic Pex
Basin	16mm	Plastic Pex
Sink	20mm	Plastic Pex
BathTub	16mm	Plastic Pex
Shower	16mm	Plastic Pex
EL.W.H.	20mm	Plastic Pex

Electric water Heater  
EWH 50 Lt 1.5 kW

PUMPS SCHEDULE

PUMP DESIGNATION	LOCATION	Quantity	FLOW (L/S)	HEAD (m)	ELECTRICAL DATA			QUANTITY			TYPE
					ESTIM. KW	PHASE	VOLT	DUTY	STAND BY	TOTAL	
DCWP#1	NEAR TANKS	1	1.5	30	1.0	1	220	1	0	1	BOOSTING PUMP

1. PUMPS HEAD AND MOTORS SIZE TO BE VERIFIED AND ADJUSTED IF NECESSARY BY THE CONTRACTOR UPON FINAL SELECTION OF EQUIPMENT, AND COMPLETION OF SHOP DRAWINGS WITHOUT ANY EXTRA COST.

2. PRESSURE REDUCING VALVE SHALL BE ADDED FOR EACH FLOOR AS NEEDED TO MAINTAIN THE SUITABLE PRESSURE.

AIR CONDITIONING NOTES:

1. ALL AC UNITS SHALL BE OF FULL DC INVERTER TYPE - OUT DOOR UNIT INSTALLED ON NEAREST ROOF.
2. ALL REFRIGERANT PIPES SHALL RUN INSIDE WALL AND UP TO OUT DOOR UNITS AT ROOF UNLESS SHOWN ON DRAWING.
3. ALL REFRIGERANT PIPES SHALL RUN INSIDE WALL AND SLABS THROUGH PVC SLEEVE WITH SUITABLE SIZE.
4. DRAIN PIPE SHALL BE CONNECTED TO NEAREST FLOOR DRAIN OR FREE DISCHARGE OUT SIDE DOWN TO GROUND LEVEL.
5. FINAL LOCATION OF THE INDOOR AND OUT DOOR UNITS SHALL BE AS APPROVED BY THE ENGINEER AND WITHOUT ANY EXTRA COST.

AIR CONDITIONING LOADS (AC)  
SELECTED BASED ON 37 DB, 20 WB OUTDOOR CONDITION / 24 DB, 18 WB INDOOR CONDITION.

INDOOR UNITS	COOLING (KW)	HEATING (KW)	QTY.	ELECTRICAL DATA			REMARKS
				V	Hz	KW	
IU-1	7.00	7.00	1	230	1	1.6	(2.0 TON)

EXHAUST AIR FAN

No.	L/s	PA	TYPE	QTY	ELECTRICAL (KW)
EXF-1	50	0.0	WALL MOUNTED	5	0.08

ALL FANS SHALL BE WITH EXHAUST LOUVER FITTED WITH BIRD SCREEN AND GRAVITY SHUTTER.

M/H SCHEDULE

MANHOLE	T.L.	E.L	L.L	Depth m	MANHOLE TYPE
MH1(60X60)	0.0	-0.35	-0.40	0.40	M DUTY
MH2(60X60)	0.0	-0.40	-0.75	0.75	M DUTY

٢٠٢٦	التاريخ	م عبدالله هواش ٢٥١١	رسم	م عبدالله هواش ٢٥١١	تصميم المهندس	<p>الرائد العربي معماريون مهندسون مستشارون</p>	البريموك الغريسي	رقم الحوض	الشركة العامة الاردنية للصوامع و الترميم	المالك
٣	رقم اللوحة	اعمال ميكانيك و غرفه التحكم	اسم اللوحة	م عبدالله هواش ٢٥١١	تدقيق المهندس		٨٤	رقم القطعة	الرمثا	الموقع